

**TYPE "D" CURB**  
N.T.S.

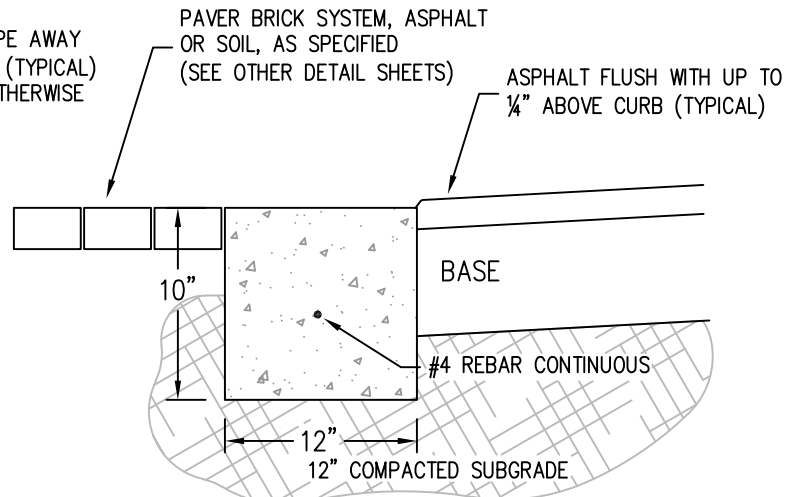

**HEADER CURB**  
N.T.S.

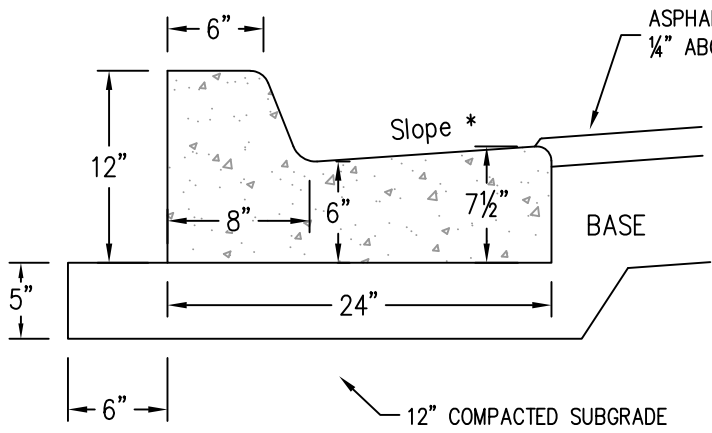

**TYPE "F" CURB**  
N.T.S.

**\*NOTES:**  
WHEN USED ON HIGH SIDE OF ROADWAYS, THE CROSS SLOPE SHALL MATCH PAVEMENT SLOPE, AND LIP THICKNESS SHALL BE 6" MINIMUM. (SEE FDOT INDEX 300)

ASPHALT FLUSH WITH UP TO 1/4" ABOVE CURB (TYPICAL).  
ON PAVEMENTS WITH BIKE LANES MAX LIP SHALL BE 1/8".

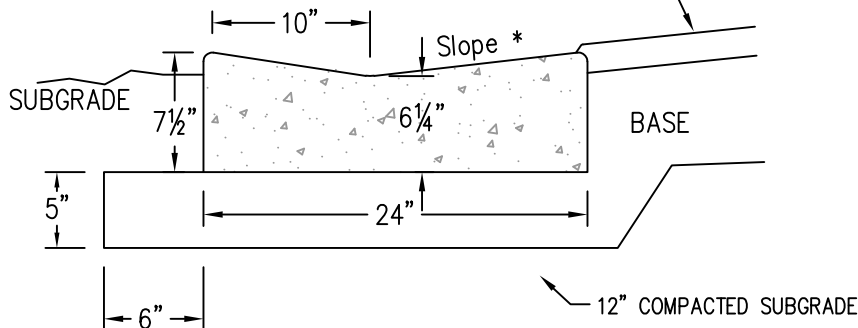

**VALLEY GUTTER/DROP CURB**  
N.T.S.

**GENERAL NOTES :**

1. SAWCUTS REQUIRED AT 10' CENTERS WITHIN 48 HOURS OF POUR FOR ALL CURB TYPES.
2. ALL CONCRETE STANDARD MIX - MIN. 3000 PSI IN 28 DAYS
3. REFER TO FDOT INDEX 300.
4. 12" DEPTH SUBGRADE COMPACTION TO 98% MAX DENSITY PER AASHTO T-180.
5. BASE COMPACTION TO 98% MAX DENSITY PER AASHTO T-180.



**TOWN OF JUPITER**  
ENGINEERING DIVISION  
210 MILITARY TRAIL  
JUPITER, FLORIDA 33458  
(561) 746-5134

**TYPICAL CURBING**  
DETAIL AND REQUIREMENTS

DETAIL NUMBER

**106**

Revised 20190403